



File Name: Canon ef 25 ii manual.pdf

Size: 2574 KB

Type: PDF, ePub, eBook

Category: Book

Uploaded: 15 May 2019, 14:22 PM

Rating: 4.6/5 from 780 votes.

Download Now!

Please check the box below to proceed.



I'm not a robot



reCAPTCHA
[Privacy](#) - [Terms](#)

Book Descriptions:

Canon ef 25 ii manual



Extension tubes are thus commonly used for macro photography and sometimes for closeup portraits. It is also quite common that customers throw out User manuals are also Try Google Search! Kit RODLNKFM Rode RodeLink Wireless Filmmaker Kit RODLNKFM Posted by Rick 20200818 143821 Hello, could you please send me rodelink filmmaker manual in spanish. Thank you in advance However, when I charge it, the red light become green for a second and then still on the charge starts to flash red again. Manual please Jammin iRocker Electronic Drum Set IROCKER Posted by Sparky 20200815 215729 Manual Please Thanks. On a 5DMk4 across different lenses, and with this extension tube mounted, it only works wide open and only in manual focus mode. Is that the expected behavior. Presumably, the lens is getting no signal from the camera. Ive cleaned the contacts to no avail. Off to Canon or is this just how these Extension Tubes work Autofocus except on TSE lenses of course and auto exposure are maintained when using these compatible lenses. There is some light lost when using extension tubes the more extension used, the more light is lost. Autofocus except on TSE lenses of course and auto exposure are maintained when using these compatible lenses. There is some light lost when using extension tubes the more extension used, the more light is lost. I bought it a while back and it sat for quite some time and I finally tried to use it. For macro I tend to shoot insects and butterflies and that type of thing. I have an inexpensive Tamron 90 mm macro lens but that generally doesnt get me close enough to skittish bugs. I actually have had some success shooting larger things like Dragonflies with a Sigma 150600 and a little bit of cropping! Oh well. Hello, Canon Service. Is that you I bought it a while back and it sat for quite some time and I finally tried to use it. Is that you An extension tube has no moving parts and no optics to potentially misalign, so its pretty lowrisk. <http://www.iqlog.su/userfiles/domino-a400-printer-manual.xml>

- canon extension tube ef 25 ii manual, canon ef 25 ii manual, canon ef 25 ii manual pdf, canon ef 25 ii manual download, canon ef 25 ii manual review, canon ef 25 ii manual free.

CANON EXTENDER EF 1.4 x II

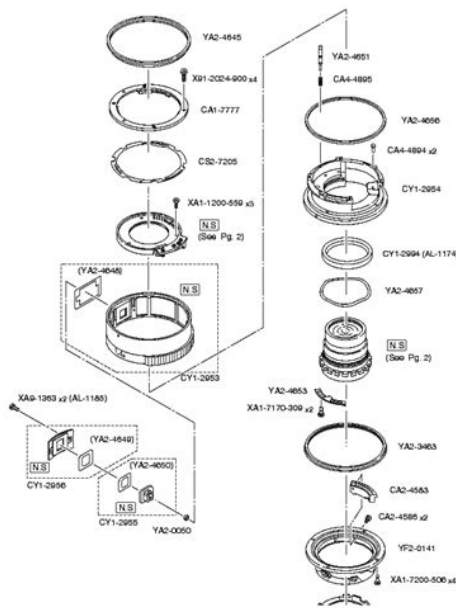

Evidently its not worth the time to repair an extension tube. Read our full review to see why its got the best autofocus system weve ever seen. 714 Olympus OMD EM10 Mark IV initial review first impressions Aug 4, 2020 at 0600 The Olympus OMD EM10 IV is the companys entrylevel DSLRshaped mirrorless camera. While it has a higher resolution sensor and new processor, its biggest focus is on selfies. 2257 Sony a7S III initial review Jul 28, 2020 at 1400 The Sony a7S III is a 12MP fullframe camera primarily designed with video in mind. We take a look beyond the specs to see what it offers to filmmakers. 1606 Olympus OMD EM1 Mark III review review Jul 27, 2020 at 1450 The Olympus OMD EM1 Mark III is our favorite Micro Four Thirds camera for stills shooters to date. In this roundup we take a look at four travel tripods and pick our favorite. In our latest buying guide weve selected some cameras that might be a bit older but still offer a lot of bang for the buck. These midrange cameras should have capable autofocus systems, lots of direct controls and the latest sensors offering great image quality. Best cameras for sports and action Aug 11, 2020 at 0146 Whats the best camera for shooting sports and action. Fast continuous shooting, reliable autofocus and great battery life are just three of the most important factors. In this buying guide weve roundedup several great cameras for shooting sports and action, and recommended the best. Best enthusiast long zoom cameras Jul 16, 2020 at 2329 Longzoom compacts fill the gap between pocketable cameras and interchangeable lens models with expensive lenses, offering a great combination of lens reach and portability. Read on to learn about our favorite enthusiast long zoom cameras. Please refer here for safety management measures against COVID19 at Canon offices and showrooms. Thank you for your understanding. If you have any further enquiries, please contact us. <http://commonwealthsportsawards.com/userfiles/domino-a320i-manual.xml>

CANON LENS EF 20-35 mm 1:3.5-4.5 USM

purchases. Get your Canon EF 25mm Extension Tube II now from Can you help right now Please choose a different delivery location. Our payment security system encrypts your information during transmission. We don't share your credit card details with thirdparty sellers, and we don't sell your information to others. Please try again. Please try again. Show details. Ships from and sold by Adorama. In order to navigate out of this carousel please use your heading shortcut key to navigate to the next or previous heading. Register a free business account Please try your search again later. They're perfectly compatible with all previous EF and TSE lenses, and will work with any EOS film or Digital SLR. Exposure compensation is often required with cameras other than the EOS1 Series. To calculate the overall star rating and percentage breakdown by star, we don't use a simple average. Instead, our system considers things like how recent a review is and if the reviewer bought the item on Amazon. It also analyzes reviews to verify trustworthiness. Please try again later. For that price I'd better be able to do some decent macro work. The good news is, this thing works better than I thought. With this ring added on, I can get right on top of something, even an inch away and still get it in focus.

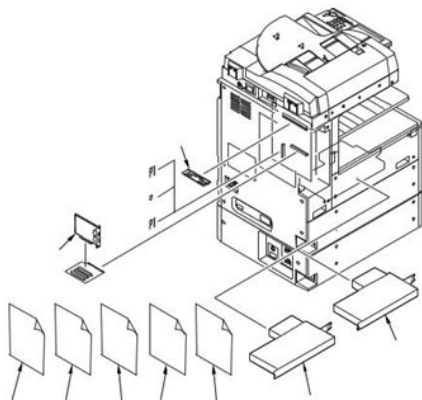

<https://www.informaquiz.it/petrgenis1604790/status/flotaganis24032022-2242>

That was my biggest concern and now I'm thrilled. For bug eyes you have to get too close to the object which would scare the bug away, so next I'll try this on my 70200 and see how that works out on loan to a friend at the moment. I'll update after I try that. I posted a pic that shows both the regular 50mm at closest focus, and the same shot with the EF25 tube added. Great unit, 4 solid stars. The only thing to review is the quality of the material and the connectors. It is the same quality you would expect from the higher end Canon lenses. You are paying a premium for this build quality too, you can get generic extension tubes much cheaper that work just as good, this is just built better and will likely last longer if you are rough on it. Realize that the ability to focus more closely will be best enhanced at shorter focal lengths. If you are considering the use of a telephoto lens to photograph objects closer than the lens minimum focus, this won't buy you much additional advantage. But it will definitely let you get closer with prime lenses whose focal lengths are shorter than 50 mm. It can also help out with longer macro lenses 100 mm for example that can focus at close distances already. Realize too that this attachment alters the focusing range of the lens. You gain some extra close-in focusing reach with this device, but what you gain at one end is lost at the other. With this extension tube in place, you will not be able to focus at infinity, so it is not an

addandforget attachment. Use it only when you need it, and for normal use mount your lens directly to the camera body. Edited to fix a couple of typos and add a point of information. But it does what it is supposed to flawlessly. I've tried it with a few different lenses, including the 50mm Canon 1.8f prime lens, The 70200mm 2.8f Canon L lens, and a Tamron 1755 2.8 lens. The extension tube works well with all of them.

<https://estacionsurmadrid.avanzagruppo.com/images/brother-pe150-embroidery-machine-manual.pdf>

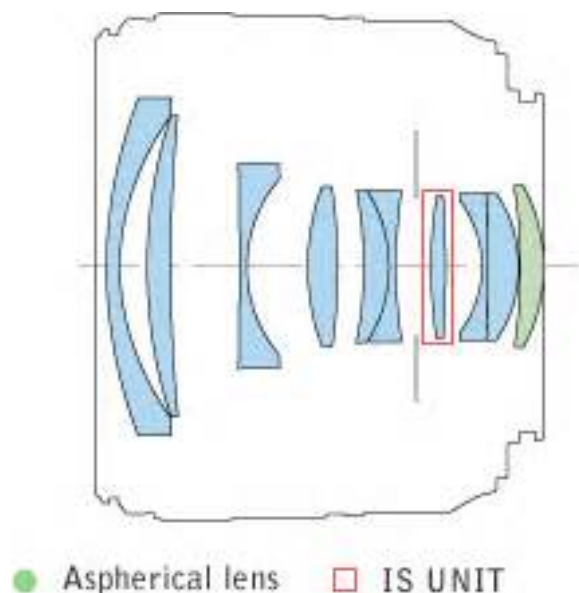

Autofocusing was a little sketchy especially in lower light situations I recommend using manual focus. The lens tube is very easy to put in your camera just like any other lens, and it is also quite simple to connect and disconnect your lens. Its a great addition to my kit and will be nice to have around when I spot a good opportunity for a close up macro shot. I found this. I found this one works only well on the tele lens. If you use it on wide lens, you have to approach the object very closely or even cant get focus. Although the auto focus works, its really really slow. Manual focus may be the only option. There were few instances where I just wanted to get closer to the subject. I didn't buy multiple ones to stack together but I find this one to be exactly what I needed. It clicks on and removes just like a lens. Comes with a pouch and cover when it's not in use. Sorry, we failed to record your vote. Please try again You can get closer focus with this or the 12mm unit also made by Canon. Sorry, we failed to record your vote. Please try again It came in handy for some trials, and I need to use it more which may change my rating to a higher star count. Sorry, we failed to record your vote. Please try again Sorry, we failed to record your vote. Please try again In order to navigate out of this carousel please use your heading shortcut key to navigate to the next or previous heading. Discover a world of detail. Shoot like a pro. EOS1D X Mark II Comparison Discover what makes the EOS1D X Mark III the fastest, most powerful EOS we've ever built If you love it, vlog it. EOS1D X Mark II Comparison This will cover all orders placed from March 1st, 2020 until further notice. Exceptions apply PayPal Credit is a trading name of PayPal Europe S.a.r.l. et Cie, S.C.A., 2224 Boulevard Royal L2449, Luxembourg. PayPal Credit is only available on the final basket value of 199 and over after promotional vouchers and discounts. Subject to status. Minimum payment and other terms apply.

<http://esteticistapilarruiz.com/images/brother-pe300s-manual.pdf>



Discover a world of detail. Shoot like a pro. EOS1D X Mark II Comparison Discover what makes the EOS1D X Mark III the fastest, most powerful EOS we've ever built If you love it, vlog it. EOS1D X Mark II Comparison Delivery within 35 working days. This will cover all orders placed from March 1st, 2020 until further notice.Exceptions apply. There are four different types of EF 100 mm lens for Canon. Certain lenses are best for macro photos, whereas other lenses are good for taking pictures of subjects from a distance. There are three versions, the original, a second that adds a USM autofocus motor, and a recently released L series version that incorporates Image Stabilization IS. Despite the macro designation, the lens can focus to infinity like regular lenses. As such, it is appropriate for use as a portrait lens. This is the first lens on the market to incorporate Canon's new Hybrid Image Stabilization Technology. Hybrid IS effectively compensates for both angular and shift camera shake during closeup shooting. It is also a stop faster. Therefore, it can act as an excellent general-purpose lens. It can be used for candid, street photography, and other situations where a somewhat narrower field of view compared to the standard 50 mm lens is useful. Its fast maximum aperture lends itself to lowlight photography like standard lenses, with excellent performance wide open. By using this site, you agree to the Terms of Use and Privacy Policy. You must have JavaScript enabled in your browser to utilize the functionality of this website. Inserting an extension tube between a lens and a camera can increase the magnification at closeup photography, depending on the master lens used. Autofocusing continues to work reliably, but manual focus is recommended in most instances. Canon Hongkong Company Limited.

It is a simple way to enable closeups at high magnifications by increasing the distance between the lens and the film plane enabling focusing at closer distances than otherwise possible. Ideal for nature photography with single focal length telephotos. Manual focusing is recommended. Click [here](#). When you put an extension tube between the lens and the camera, your focus distance decreases, so you can focus on things closer than you would be able to without the tube. The caveat is that they also reduce the maximum focus distance, so once fitted, you can no longer focus on infinity. The wider the lens, the more drastic the change in focus distance. With wide angle lenses, you almost touch your subject before you get it in focus. It can give you some fun effects, but not that practical. Tubes work best with 50 to 100mm lenses, or even with very long lenses that usually have very long minimum focus distances, to allow you to shoot small birds quite large in the frame. Many people use extension tubes for macro or closeup photography, to get larger than lifesize, or 11 magnification. Having just bought a second 25mm extension tube Canon Extension Tube EF 25 II , to give me 50mm, or 62mm with the 12mm extension tube also fitted, and also after receiving a question on my Canon EF 100mm F2.8 L Hybrid IS Macro lens review blog post, I figured I'd do a few tests to see how the combined extension tubes and a Canon 1.4X Extender effect the

magnification of the lens. Play Time! The 5D Mark II sensor dimensions are 24x36mm, the same size as a 35mm film frame. This means that when shooting at lifesize, something that is 36mm wide would be 36mm on the sensor. For my tests I cranked the focus back as far as it would go, and focused with focusing rails, to get as close as possible. The first thing I noticed as I framed the first test image is that the 100mm F2.8L IS MACRO lens actually focuses slightly larger than 11, or lifesize, as the resulting image included just 34.

<https://pmdrecycling.com/wp-content/plugins/formcraft/file-upload/server/content/files/16270c0717c57c---bottle-warmer-user-manual.pdf>

5mm of a steel rule. This means that right off the bat, we are actually shooting at 1.041, but to show the effect of the extension tubes and 1.4X Extender, I'm going to use 11 as the base. Here are the images, straight out of the camera, with no cropping or rotation or anything though resized for Web of course. First, just the straight 100mm F2.8 L IS MACRO lens, with nothing attached, giving us a slightly larger but as good as lifesize image Straight 100mm 11 Lifesize This is with one Canon 25mm extension tube attached. This results in 1.351 magnification below One 25mm Extension Tube This is with two Canon 25mm extension tubes attached, giving us 50mm of extension. This results in 1.731 magnification below Two 25mm Extension Tubes 50mm Next I added the Canon 12mm extension tube to the two 25mm tubes, giving us 62mm of extension. Here's a table of the results, for quick comparison. I own the Canon Canon MPE 65mm F2.8 15x Macro lens as well, but I don't always take it out, unless I know I'm going to specifically shoot macro. Also, although I haven't yet tested this, I'm sure the Hybrid IS works to a degree, even when shooting larger than lifesize, so that is another advantage over the 65mm. The whole setup does get pretty long with 62mm of tubes and the 1.4X Extender, which can be good for getting close to your subject, but also makes it a little more difficult to balance than the MPE 65mm macro lens. One other benefit of the 100mm with tubes, is that you have some focusing leeway. With the MPE 65, you have no focus mechanism as such, although you can increase or decrease magnification which does move the focus. Basically though, you have to use a focusing rail and move whole setup camera and lens back and forth to focus. One other thing to note is that I was impressed with the image quality right through the range. The whole series are pretty impressively sharp, to say that I'm sticking a lot of distant and even glass with the 1.

<http://www.abvent.com/emailing/files/briggs-u0026-stratton-lawn-mower-engine-manuals.pdf>

4X Extender, between the 100mm Macro lens and the camera. I'm not sure that I'll use all of these tubes and the 1.4X Extender in the field, but it's good to know that it's there as an option. By all means compare with other vendors, but if the price is right, support this blog and podcast by buying from these links. Here is this posts shortlinkShare 1 Pocket Email Tweet Share 1 Shares Hes a pioneering Podcaster and blogger, Capture One Brand Ambassador, and XRite Coloratti member. When I first read this I was a bit disappointed, but evidently it worked for you, so I wonder why the warning in the manual. Cheers, Steve Martin Bailey It's a good question about whether or not having the Extender at a different position would change anything. All components have electronic terminals, so I imagine there's nothing to stop you from having say a 25mm tube, the Extender, then another 25mm tube. Bearing in mind though that the Extender is the most sturdy of the extensions, I'd suggest always putting the Extender on the body first, then attaching the tubes after that. Especially as this removes the risk of the Extender hitting the back of the lens. Cheers, Martin. Phil I have no problem dealing with crop factors with regards focal lengths but thinking about it in the context of magnification is making my head hurt slightly. I guess the subject is perceived as being 1.6 times bigger on a 50D's sensor than on that of a full frame.Thanks for the kind words. I'm pleased this helped. Your 1.6X magnification will effect the image size in the same way when using the tubes. Any effect that you get from them will be magnified. Bob, Thanks for the comment, and I stand corrected. I am aware of this of course, but from a tutors perspective, the fact that this tube is

actually 27mm they're actually 12.3mm and 27.3mm to be really picky! is pretty much irrelevant. People will generally think of them as being 12mm and 25mm and that's fine in my opinion. Cheers, Martin.

Janita Sox I've got down to 51 quite happily and easily, finding not much difference with quality or difficulty from 11. That did take three complete sets of tubes though. The set up was very long but to be honest, was kind of easy, with a decent flash anyway. Am moving up to the MPE but it's been a great few months and definitely the cheaper way to 51. MPE offers ease of use and no undoing of extension tubes when you want to return to the shallows of 11 after the deep of 51. I'm just going to add tubes onto the MPE anyway. There's no stopping me. I have a question about 3D subjects as opposed to 2D. Have you done any tests to determine DOF relating to various extensions and the other lens variables. My initial tests have been with some passive extensions and lenses from my Olympus OM2 I still have from 35 years ago, and an adapter for my Canon which is set to manual. I wanted to play before leaping in and buying modern gear to see if it was worth it to me. I was shocked with 65 mm of extension and a prime 50 mm f1.8 lens at the shallow DOF even at f11 and smaller. A sugar ant's head was only in focus at one small part. Scary as hell! LOL. I tried to increase the DOF, testing various lenses and f stops but nothing seemed to help, but this could be related to my weird lash up I guess, perhaps the adapter is throwing things off. I was working under brilliant Florida sun too, so no shortage of light. I had so much fun though, I am going to buy the proper gear so I can use my Canon lenses. Thanks again for this page, it is very helpful. Martin Bailey The closer things get, the shallower the depth of field. Use any online DoF Calculator and punch in the details to check this. One problem you may have though is finding out exact how much magnification your tubes are giving you. Cheers, Martin. Rick Kimmick I applied this technique using my Canon 60D, the EFS 50mm macro lens, and my set of ext. With the APSC in the Canon at 22.2mmx14.

8mm I rolled the lens alone to the far position just past the 11 mark. I was at 1.061 not bad. Once I put the ext tubes on, it jumped to 2.541. Of course give or take a little for human error. Barbara My question has more to do with how far you can get from your subject. The 100mm is IS, so easy to use handheld, while the 180mm would work better on a tripod. So I'm considering using a 12mm extension tube and a 1.4X teleconverter on the 100mm lens. How will this affect the focusing distance for 11 magnification Thanks. Martin Bailey With a 12mm extension tube, you will get a 1.17x magnification at the closest focus distance, so you could move a little way from the subject and still get a 11 image. If you add the 1.4X Extender, you will of course magnify the image, so you'd essentially be getting a 1.5X larger image, or maintain more distance for a 11 image. I hope this helps. Regards, Martin. Paul Ridges I will post the results on my blog Martin Bailey Thanks for taking the time to let me know. Regards, Martin. Hugh Howell Thanks for your great articles. Regards Hugh Martin Bailey I sometimes end up with so much Extension that I can't autofocus, and I will then use manual focus for stationary subjects. If the subject is moving, I'd be more likely to use less Extension and maintain at least the center focus point. You're very welcome, for the articles. Thanks for stopping by and commenting. Regards, Martin. Post A Comment Cancel Reply Save my name, email, and website in this browser for the next time I comment. Notify me of followup comments by email. Notify me of new posts by email. Learn how your comment data is processed. Take a look around, and if you need anything, drop us a line! View our Cookies Policy OK, got it. Click OK to extend your time for an additional 30 minutes. Can be used with most EF lenses; ideal for nature photography with single focal length telephotos. Manual focusing is recommended. Magnification for standard zoom lenses is about 0.7x or more.

By continuing to use the site you agree to our use of cookies. Find out more Choose from the full product list The Japanese company has been headquartered in Tokyo since its inception. Canon is particularly associated with the production of digital cameras and accessories, where they remain the leading innovator and producer of imaging solutions. Aside from digital cameras, the company

also operates in the production of office equipment, particularly copiers or printers. If you want to use the chat log, please. Prohlednete si Canon EF25 II. Prezrite si Canon EF25 II. This time, I'm going to write about another accessory you can buy, extension tubes. The further forward the element, the closer your lens can focus to your subject. An extension tube is a hollow, lighttight tube that fits between your lens and your camera mount. It moves your lens further from the camera, and the front element closer to the subject. The closer you can focus, the more magnification you get. If your lenses don't have manual aperture rings ie the aperture setting is controlled by the camera then the lens aperture will remain locked open at the widest aperture. While wide apertures can be used creatively, the narrow depth of field you get with closeup photography means that you usually need to stop down to get a large enough zone of sharpness to suit the image. The camera controls the aperture settings, and you can use any automatic exposure mode and also autofocus although it is often easier to focus manually when you're working closeup. You can see the electrical contacts in the extension tubes. But if you can, you should buy the second type of extension tube, which is one that maintains the electrical connection between the lens and the camera body. Sony doesn't, but you can buy them from third party manufacturers like Kenko and Vivitar, who also make extension tubes for Canon and Nikon. These tubes are all of the second variety.

But if you're a Pentax user, you can buy the first type of extension tube I mentioned easily enough, as long as you're willing to work within the limitation of losing the lens to camera electrical connection. They are less effective with telephoto lenses. The focal length of the lens you intend to use for your closeup work may determine which is the best accessory to buy. If you buy a set, you can join two extension tubes together to give you even more magnification. Adding an extension tube increases the effective aperture of the camera lens, which means you need to use either a longer shutter speed or higher ISO to compensate for the loss of light. Your camera, if it's set to an automatic exposure mode, will take care of this automatically for you. You can use the manual focusing ring on your lens to focus on the subject. Don't be afraid to raise your ISO in order to get a small enough aperture to give you adequate depth of field. The extra magnification also magnifies camera shake as well as the subject. I like to use them for taking photos of flowers. I also had a lot of fun taking photos of my girlfriend's eye the opening image to the article. It's a good illustration of how close you can get if you stack enough extension tubes together. He's an experienced teacher who enjoys helping people learn about photography and Lightroom. Join his free Introducing Lightroom course or download his free Composition PhotoTips Cards ! We won't share it with anyone We won't share it with anyone. What Is an Extension Tube. An extension tube is a spacer that sits between your lens and the camera body to alter the MFD minimum focus distance. The MFD of a lens is a measurement of the closest point a subject can be from the camera's sensor, whilst still being able to focus. If a subject is closer to the sensor than a lens' MFD, you cannot focus on that subject.

The thicker the extension tube used on a lens, the higher the lens magnification becomes as you're able to move the lens much closer and still achieve focus. What all this means is that you can turn a normal lens into something with much a much higher magnification factor to achieve macrolike images, without needing a dedicated macro lens. Later in the article I will discuss the knock on image quality issues caused by extension tubes, but the other important thing to realise is that when extension tubes are in place, you can no longer focus all the way to infinity. This has few practical implications because most people are using extension tubes to try to focus on something at a very close distance, but it's worth knowing so that you don't think your lens is broken when you find it's no longer able to focus on something further than a few feet away. It's for this reason that you can't practically leave an extension tube in place all the time, so it's something you need to carry in your bag and use when it makes sense to do so. How Do Extension Tubes Affect Image Quality. Unlike teleconverters, extension tubes have no optics in them at all so in some circumstances they have very little effect on image quality. The tricky thing about point is that every lens reacts very

differently to using extension tubes, so it's hard to deliver a sweeping answer to this question. When manufacturers design the optics inside a lens, they take into account things like barrel distortion and pincushion distortion, and try to correct for it as much as possible. Focusing a lens does move the optics inside a lens, so that means that the amount of distortion varies depending on how far away your subject is from the lens. Lens designers try as hard as they can to correct for distortion at the most important points in a lens' focus range, but essentially what it means is that some lenses are sharper than others when they are used at the minimum focus distance.

<http://www.bouwdata.net/evenement/4-in-1-manual-treadmill-price-in-chennai>