

98 tippmann custom manual

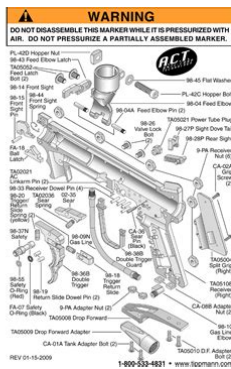
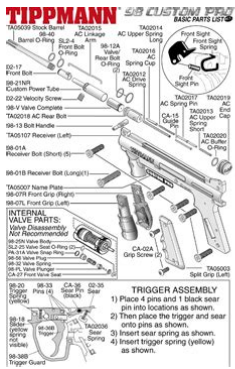

File Name: 98 tippmann custom manual.pdf
Size: 4929 KB
Type: PDF, ePub, eBook
Category: Book
Uploaded: 19 May 2019, 12:56 PM
Rating: 4.6/5 from 561 votes.

Status: AVAILABLE

Last checked: 3 Minutes ago!

In order to read or download 98 tippmann custom manual ebook, you need to create a FREE account.

[**Download Now!**](#)

eBook includes PDF, ePub and Kindle version

- [Register a free 1 month Trial Account.](#)
- [Download as many books as you like \(Personal use\)](#)
- [Cancel the membership at any time if not satisfied.](#)
- [Join Over 80000 Happy Readers](#)

Book Descriptions:

We have made it easy for you to find a PDF Ebooks without any digging. And by having access to our ebooks online or by storing it on your computer, you have convenient answers with 98 tippmann custom manual . To get started finding 98 tippmann custom manual , you are right to find our website which has a comprehensive collection of manuals listed.

Our library is the biggest of these that have literally hundreds of thousands of different products represented.



Book Descriptions:

98 tippmann custom manual



Preview Tippmann Paintball 98. The Tippmann 98 paintball gun is known worldwide. Tippmann SL68 II Gun Generation 2 Manual, Tippmann 98 Custom Cyclone Feed Hopper Manual, Tippmann TiPX Gun Diagram, Tippmann C3 Gun Manual. This free owners manual is the same one that originally came with your marker. Download the Crossover Manual for complete operation instructions. 98C Platinum Series Exploded View. Drawable hdpi resolution for funeral, Peavey kb a15 owners manual, Guide words lessons, Balakirsky elena c md5 example, Rent receipt hra. Reload to refresh your session. Reload to refresh your session. File Type Extension pdf. PDF Version 1.3. Linearized Yes. Create Date 20090117 070108. Producer Acrobat Distiller 4.0 for Windows. Subject ToErichForWEBC3Schematic022806. Author Rich. Creator Adobe PageMaker 6.52. Modify Date 20090220 1116160500. Page Count 1. Discover everything Scribd has to offer, including books and audiobooks from major publishers. Start Free Trial Cancel anytime. Report this Document Download Now Save Save Tippmann 98 Custom Pro Manual For Later 0 ratings 0% found this document useful 0 votes 91 views 24 pages Tippmann 98 Custom Pro Manual Uploaded by Werewolves Pb MilSim Description Full description Save Save Tippmann 98 Custom Pro Manual For Later 0% 0% found this document useful, Mark this document as useful 0% 0% found this document not useful, Mark this document as not useful Embed Share Print Download Now Jump to Page You are on page 1 of 24 Search inside document Browse Books Site Directory Site Language English Change Language English Change Language. This amount is subject to change until you make payment. For additional information, see the Global Shipping Programme terms and conditions opens in a new window or tab This amount is subject to change until you make payment. If you reside in an EU member state besides UK, import VAT on this purchase is not recoverable.<http://www.96stone.ru/userfiles/epson-powerlite-1716-manual.xml>

- **tippmann 98 custom manual, tippmann 98 custom owners manual, tippmann 98 custom manual pdf, tippmann 98 custom pro manual, tippmann 98 custom instruction manual, tippmann 98 custom act manual, tippmann 98 custom repair manual, tippmann 98 custom pro manual pdf, tippmann 98 custom e trigger manual, tippmann 98 custom platinum series manual, 98 tippmann custom manual, 98 tippmann custom manual pdf, 98 tippmann custom manual download, 98 tippmann custom manual free, 98 tippmann custom manual for sale, tippmann custom 98**

Assembly Instructions

- 1.) Remove the existing barrel
- 2.) All Model 98's and 98 Customs under 8,000 (serial #), skip steps 3 & 4.
- 3.) Refer to your owners manual: Remove cover or left half of receiver.
- 4.) Remove rear sight assembly & put left receiver half back on. (skip steps 5 & 6)
- 5.) Remove sight by removing the E-clip on the adjuster screw.
- 6.) Remove screw & sight assembly

FLATLINE
BARREL SYSTEM



Installing Flatline barrel, adapter, and shroud

- 1.) Loosen 3 bolts on the receiver in order to take the tension off of the barrel area.
Location of 3 bolts
 - Bolt 1: at front sight
 - Bolt 2: at front grip
 - Bolt 3: above trigger guard
- 2.) Install Flatline adapter.
 - Align the adapter so that the pinch bolt tab is centered in the 6 o'clock position.
- 3.) Install Flatline shroud.
 - Remove the bolt from the rear of shroud.
 - Install shroud on top of the gun and insert screw through the hole in the rear sight, then tighten.
- 4.) Install barrel.
 - Apply oil to the inside surface of the barrel adapter.
 - Apply oil to the outside surface of the barrel up to the end of the flat notch.
 - Slide barrel through handle with the flat notch on top.
 - Once the barrel starts into the adapter, tap (using a rubber mallet) the front of the new barrel to make sure it slides all the way into the adapter.
 - Re-tighten all three receiver bolts.
 - Tighten adapter pinch bolt.

NOTE:

If the flight of your paintballs is consistently to the right, you will need to loosen the adapter pinch bolt and rotate the barrel counter clockwise. If the paintballs fly to the left, rotate the barrel clockwise.



There are a lot of small parts that may come out and get lost, so be sure to look at the half that you just took off and make sure their aren't any parts hanging off or still attached. I have found it easier to place all the parts on the right half so I can see everything at once. Pictures of the 98 Custom internals for both stock 98C and EBolt with Low pressure kit The newer 98 Customs may look a little different around the trigger group and hose assembly into the valve. But for the most part, the rest is the same. The major items you want to keep track of are all the little pins that make up the trigger assembly and the orange ball detent under the front bolt. The pins keep the trigger, trigger sear, and sear spring in the correct position and can slide out quite easily so be careful and keep an eye on them. The orange part is the ball detent. This prevents the paintballs from double loading in the breach or just rolling out the barrel. It is a good idea to inspect the detent and make sure the front part sticking up isn't pressed flat to the bottom. If it is, you will need to replace it. Click here to pick up a manufacture replacement from one of my favorite sellers on Ebay. Make sure the ball detent is placed in the breach correctly see pictures above. If placed backwards, the bolt will either stop short or cut the detent in half. Cleaning the 98 Custom Internals With the two halves separated, it is now easy to clean the bolt and hammer. First, remove the rear cap where the main spring inserts into all the way in the rear of the marker. This removes the spring tension on the system allowing you to easily remove the hammer, linking arm and front bolt. The hammer is made of 3 parts; the hammer, the internal plug, and the cocking arm. You will notice that the spring goes in this part when all 3 parts are assembled correctly. You may have to rotate the cocking arm to fully reinsert the main spring.

When cleaning old broken paint or gunk from the breach or hammer channel, take a damp rag and wipe off the front bolt, hammer, and the channels where they slide back and forth. After they are dry, apply paintball oil or grease to the locations you just wiped down. Make sure to put a little oil on the bolt and hammer orings to help prolong their life. I like to use Dow33 grease for the main friction points on the bolt bodies as it provides long term lubrication compared to the oil, but you still want to use synthetic paintball oil on the orings themselves. Tippmann 98 Custom Valve Disassembly Lets go over how to disassemble the Tippmann 98 Custom Valve. The one pictured below is an older version, the newer ones don't have a threaded hose input. Disassembly is still the same. My orings are different colors as they are part of my master oring kit from Flask Paintball.

You can pick up some by clicking here to go to their EBay shop. The 98 Custom Valve can be a PAIN to open up. This is primarily due to the spiral retaining ring. There are tools to assist in the removal and installation of the retaining rings, but it can be done with a sturdy oring pick or small flat screwdriver. I highly recommend placing it in a vice to hold the valve still. No need to apply a lot of pressure and put some cushion to prevent damage. Start by simultaneously pressing down on the brass portion, depressing it into the valve and prying the retaining ring loose. Once you have the retaining ring is removed, you can then remove the valve internals and inspect the orings. If the valve was leaking, check both orings and make sure they haven't turned to goo. Inspect the front valve seat and cup seal for damage. When putting everything back in the valve, place the oring first and then insert the front valve seat firmly in place with a dowel or middle of a barrel swab. Then lightly oil and insert the rest of the internals. Installing the retaining ring can be just as much of a pain as taking it out.

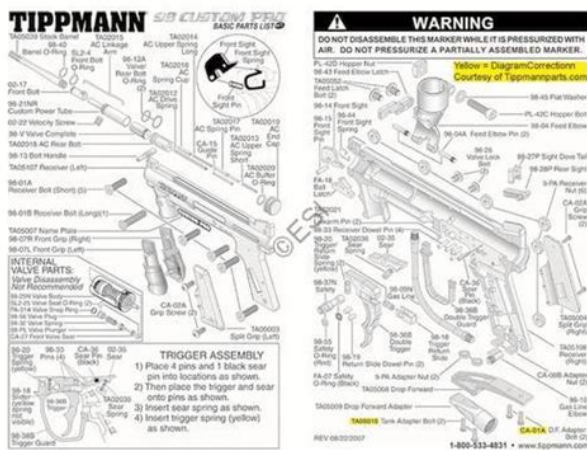

<http://www.familyreunionapp.com/family/events/boss-35-farad-capacitor-manual>

Start by spreading out the ring, pressing the brass valve plug into the valve and inserting the ring around the inner groove. Once it is in, you are all set. Reassembling Your 98 Custom Reassembly is exactly the reverse of disassembly. Make sure the ball detent is placed correctly and all the pins are in the correct locations. Tip The main things that will get in your way when putting the halves back together are going to be the trigger guard, ASA screw assembly, and rear sight. Some other things you can do to help prolong the life of the marker is put about 5 drops of oil into the ASA, air it up and shoot it a few times. This will put some lubrication into the valve lubricating the internal orings. Tippmann 98 Custom Modifications The mods that I have found to be most effective are polishing the internals, lightening the trigger spring, and eliminating hopper wobble. Polishing the Internals Polishing the internals can be a pain but will prolong the life of the internal parts. The older 98 customs have some excess overspray from the outside in the hammer and front bolt channels. This can cause excessive wear on the moving parts. I have found that the best way to clean out the overspray is with a small rotary buffing tool like a Dremel with a buffing wheel and buffing compound. You can do it by hand with sandpaper too, start off with 500 to 1000 grit paper and polish it off with 2000 grit for best results. The locations you will want to focus on are the front bolt channel, hammer channel, linking arm channel, and the trigger grouping face where all the trigger pins are. Don't take off too much material, just do enough to smooth everything out. This won't be a quick job. The last time I did it with a buffing tool, it took me a good hour or so to get both halves

cleaned out to my liking. One of my halves after a few years of play and some DOW 33 still on it
 Lighten the Trigger Return Spring The trigger return spring on the stock markers are quite stiff.

<http://kampongtourist.com/images/canon-service-manual-ip4300.pdf>

Assembly Instructions

FLATLINE BARREL SYSTEM

- 1.) Remove the existing barrel
- 2.) All Model 98's and 98 Customs under 8,000 (serial #), skip steps 3 & 4.
- 3.) Refer to your owners manual: Remove cover or left half of receiver.
- 4.) Remove rear sight assembly & put left receiver half back on. (skip steps 5 & 6)
- 5.) Remove sight by removing the E-clip on the adjuster screw.
- 6.) Remove screw & sight assembly

Installing Flatline barrel, adapter, and shroud

- 1.) Loosen 3 bolts on the receiver in order to take the tension off of the barrel area.
 - Location of 3 bolts**
 - Bolt 1: at front sight
 - Bolt 2: at front grip
 - Bolt 3: above trigger guard
- 2.) Install Flatline adapter.
 - Align the adapter so that the pinch bolt tab is centered in the 6 o'clock position.
- 3.) Install Flatline shroud.
 - Remove the bolt from the rear of shroud.
 - Install shroud on top of the gun and insert screw through the hole in the rear sight, then tighten.
- 4.) Install barrel.
 - Apply oil to the inside surface of the barrel adapter.
 - Apply oil to the outside surface of the barrel up to the end of the flat notch.
 - Slide barrel through handle with the flat notch on top.
 - Once the barrel starts into the adapter, tap (using a rubber mallet) the front of the new barrel to make sure it slides all the way into the adapter.
 - Re-tighten all three receiver bolts.
 - Tighten adapter pinch bolt.

NOTE:
 If the flight of your paintballs is consistently to the right, you will need to loosen the adapter pinch bolt and rotate the barrel counter clockwise. If the paintballs fly to the left, rotate the barrel clockwise.

This is a quick fix, just take a clicky pin and take out the spring, cut to size and replace the stock spring. Super easy to do and costs you one pen. Eliminate Hopper Wobble The way to eliminate hopper wobble is to wrap an oring around the feedneck base, adding extra material between the body and the feedneck. To do this, just wrap a regular tank oring or similar sized around the base of your feedneck as shown below. To remove your feedneck, just unlatch it by pressing down on the front sight and pulling the feedneck back towards the trigger. Take your oring and wrap it around the bottom of the feed neck where the pins are at, stretching the oring and stopping just below where the paint feeds. This will put more pressure between your feed neck and the body and will not let the hopper wobble at all. Prevent Paint From Popcorning Sometimes if you are low on paint, the balls in the feedneck will blow back up in the feedneck after each shot. This is caused by the residual air slipping past the bolt and shooting up the feedneck. This popcorn effect can be reduced by simply drilling a few holes in the back of the feedneck. This allows the air to escape out the holes rather than forcing its way up and out through the hopper. A Yes it can and you don't need to change any internal parts. You may need to increase the velocity if switching from CO2 to HPA, but the marker will function exactly the same. Q Is the 98 Custom considered a woodsball marker or a speedball marker. There are some upgrades to make a 98 Custom fit in a bit more to the speedball field and increase the overall functionality of the marker. Examples are the EGrip and EBot an electropneumatic controlled ram allowing for higher rates of fire than the stock mechanical trigger and a double trigger upgrade kit. Q What are some upgrades I should get. A Well, if you want more accuracy, get a new barrel.

<http://itechsystem.fr/images/canon-service-manual-mp530.pdf>



If you want speed and you have one of the new 98 custom pros, get the egrip upgrade, if you have an older model like I do, pick up an RT upgrade kit. Recent Content link to Complete Guide to Beginner Pump Paintball Guns and Accessories Complete Guide to Beginner Pump Paintball Guns and Accessories After playing pump paintball for the past 15 years, I have owned and used quite a bit of pump paintball gear on the field. I have used everything from the super basic gear that falls apart after a. Continue Reading link to Pump Paintball vs Semi Auto Mech and Electro What is the Difference. Pump Paintball vs Semi Auto Mech and Electro What is the Difference. If you go to any paintball field today, you will probably see two different types of paintball guns being used; pump paintball guns and standard semi auto paintball guns in either mechanical or. Continue Reading About Me Howdy. I'm Brian and this is where I can nerd out about paintball. After being in the sport since 2001, I have learned quite a few tricks and skills. Usually, I hit the field with my pump markers but am no stranger to using magfed, mech, and electro setups as well. On this blog, I will share what I have learned over the years and anything new I run across in the future. More About Me and My Gear Legal Disclaimer This site is a participant in the Amazon Services LLC Associates Program, an affiliate advertising program designed to provide a means for sites to earn advertising fees by advertising and linking to Amazon.com. Paintzapper is compensated for referring traffic and business to amazon. There is 1 item in your cart. The Platinum Series maintains the core features of the original 98 including all aluminum die cast receiver, and quickrelease feeder elbow and it is fully compatible for CO2 or HPA.

Now, while there are markers like the Tippmann TPN Bravo One Elite and the Tippmann TPN Sierra One both very good markers as well, the 98 Custom is the marker of choice for rental use at the place where I go paintballing. This, to me, says it is a very good choice. If you are going to purchase a 98 Custom, make sure that you buy one with ACT AntiChop Technology. Allinall, the Tippmann 98 Custom is, in my opinion, the best bangforyoubuck marker available, and I would highly recommend purchasing this. This is a great gun its fully customizable. All Rights Reserved.

<http://pikewallis.no/wp-content/plugins/formcraft/file-upload/server/content/files/1628071eba125b---bsa-examination-manual-2014.pdf>

<https://www.thebiketube.com/acros-boss-1600-manual>